

NOTES:

1. MATERIAL:

- 1.1 HOUSING: Nylon 46 ,UL94V-0;
- 1.2 CONTACT: Phosphor Bronze
- 1.3 FITTING NAIL: Brass

2. FINISH:

- 2.1 CONTACT:  
50u" MIN NICKEL PLATING OVERALL  
1:Gold Flash  
N:50u" MIN Matt Tin

2.2 FITTING NAIL:

- 50u" MIN NICKEL PLATING OVERALL  
N:50u" MIN Matt Tin

3. REFLOW SOLDER CAPABLE TO 260°C PER ACES SPEC.

4. SPEC. PLS. REFER TO PS-51680-xxxxx

5. PACKAGE PLS. REFER TO 88211-XXXX-TRP

6. PART NUMBER

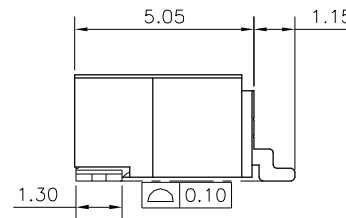
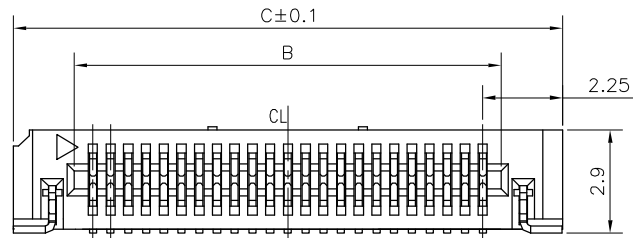

51680-XXX X X-XXX

CKT

PACKING  
0:Tape & Reel

XXX	HOUSING MATERIAL & COLOR
001	NYLON46/WHITE

PLATING

1:Gold Flash  
N:Matt Tin

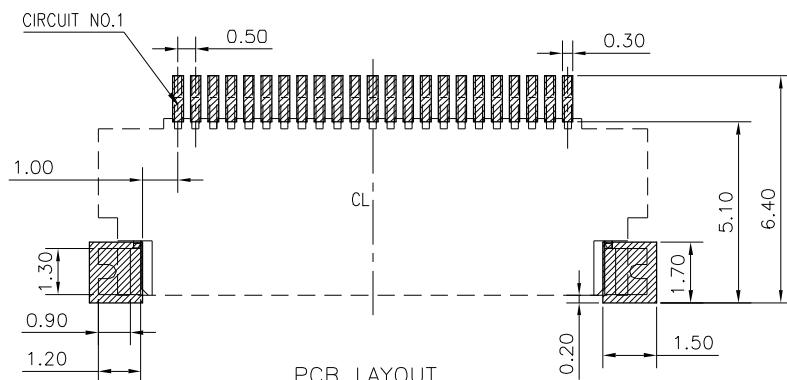

PCB LAYOUT  
RECOMMENDED TOLERANCE ±0.05

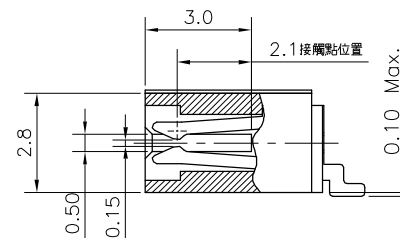

CKT	A	B	C
30	14.5	15.55	19.0

<b>QUALITY SYMBOLS</b> MAJOR Ⓢ CRITICAL Ⓢ <b>GENERAL TOLERANCES (UNLESS SPECIFIED)</b> X. ±0.5 X ±0.25 .XX ±0.15 .XXX ±0.1 ANGLES ±2°	DRAWN BY Liang,lin j CHECKED BY Lu, jing quan APPROVED BY hsieh, fu yu	DATE 20/05/01 DATE 20/05/01 DATE 20/05/01	<b>ACES ELECTRONICS</b>  <b>0.5mm NON-ZIF FPC TYPE CONN, SMT, R/A, D/C</b>
	UNITS mm SCALE 1:1	 SHEET NO. 1 OF 1	